

# L-fastener

# WCL

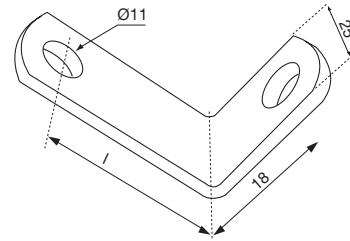

## Dimensions



### Description

Surface finish: Hot dipped galvanized.

### Technical data

Max recommended load for different fire classes.

Dim [nom]	Length [nom]	Length- Length II [mm]	Thick- nessThick- ness [mm]	Material- Material
25	35	32	4	FFZV
25	60	56	4	FFZV
25	85	81	4	FFZV
25	110	110	4	FFZV
25	35	35	4	4404

Installation	Ventilation system					Smoke control system
	R0 no fire class kg	R15 kg	R30 kg	R45 kg	R60 kg	600 °C 120 min kg
Type						
WCL	100	100	100	100	100	100

### Ordering example

